

How to pair a LINAK® Wireless control box

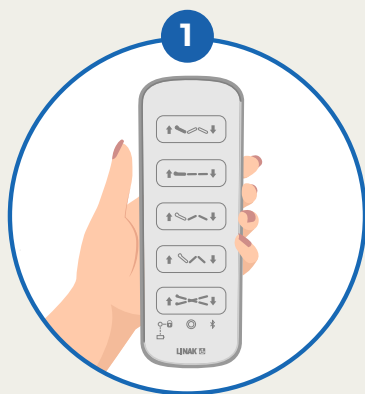

Move within two meters of the bed / application.

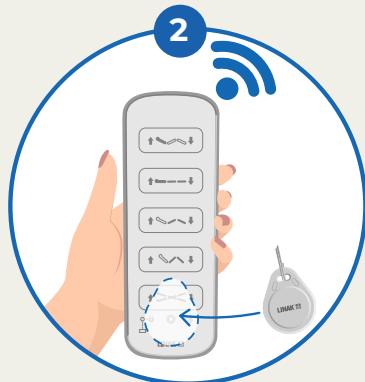

Enter Direct Pairing Mode by activating key 1 and magnet in 3 seconds.



Release key and magnet and move closer to control box until buzzer frequency change from slow to fast.

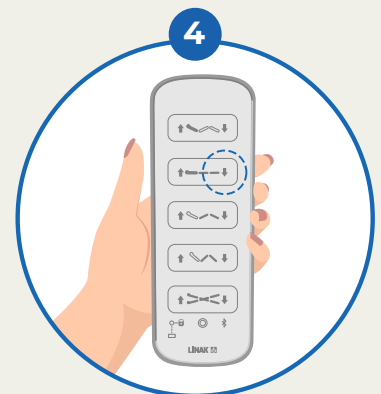

Confirm pairing by pushing key 1.

**Beep
Beep**

**Double confirmation
beep - Pairing OK**

4

3

1

